

1 Getting Started

1.1 Button Layout

Button functions for operating the helmet

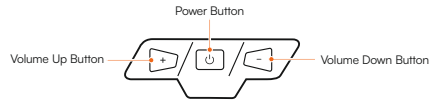

1.2 Powering On and Off

Turn on with Chinstrap

The helmet is designed for quick and effortless use with its smart chinstrap control. Simply locking the chinstrap automatically turns the helmet "ON", and unlocking it turns the helmet "OFF".

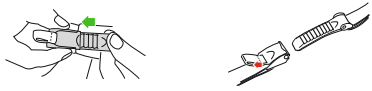

Lock the chinstrap to turn ON

Unlocking chinstrap to turn OFF

P/02

2.3 Volume Control

Press and hold the (+) button to increase the volume. Press and hold the (-) button to decrease the volume.

2.4 Track Control

Press the (+) button once to play the next track. Press the (-) button once to return to previous track.

2.5 Calling

The helmet has Environment Noise Cancellation for clearer voice calls

Answer Call: Press any button one time and to end a call press the (⏻) power button once.

Reject Call: Press & hold (⏻) power button for 2 sec to reject upcoming call.

Redialing Call: Press (⏻) power button 2 times to redial the last called number.

Activate Auto Call: Long press (+ -) volume button together for 3 sec to activate & deactivate auto answering call.

Note: Helmet remembers the last auto call ON/OFF status and automatically continues from the previous setting when the helmet is powered on again.

2.6 Activate Voice Assistant

To activate voice assistant press (+) button 2 times. E.g. "call dad" or "play my spotify".

P/06

Turn On with Buttons

To manually operate the helmet, use the middle power button on the control pad. Press and hold the power button for 3 seconds to turn the helmet ON, and press and hold it again for 3 seconds to turn it OFF.

Press & hold it to turn On /Off

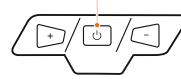

Note: The helmet will automatically power off after 5 minutes if no device is connected. It can be turned on by both modes.

1.3 Connecting the helmet to mobile

Before the connection charge the helmet sufficiently. Turn on Bluetooth on your mobile and look for available device. Select "HEADFOX TARMAC" from the list.

Note: For better connectivity keep your phone in left pocket of your jeans.

Blue LED will blink fast if not connected (pairing mode).
Blue LED will blink very slow after connected.

P/03

3 Information

Specifications

Technical Specifications:

Model:	Headfox Tarmac
Bluetooth Version:	5.3
Bluetooth Range:	~10m/33ft (without any obstacles)
Playback Time:	100 Hours (without any modes of light and sound)
Standby Time:	600 Hours
Charging Time:	2.5H
Charging Port:	Type C
Internal Speaker:	40mm Drivers
External Speaker:	5w Bass Driver
Battery Capacity:	2400 mAh

Physical Specifications:

Helmet Type:	Full Face
Shell Material:	Acrylonitrile Butadiene Styrene
Safety:	DOT and ISI Certified
Weight:	1400+50g
Water Resistance:	Rainproof
Locking:	Quick Release

P/07

1.4 Charging

The helmet can be charged using the supplied Headfox Type-C charging cable provided with helmet, or with any compatible USB Type-C charger. The LED turns red while the headset is charging and turns blue when it is fully charged. The helmet will be fully charged in about 2.5 hours.

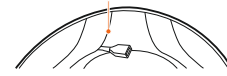

Charging Port is on left side under the padding.



Type C port

Note: Recommended for longer battery life and better performance: use the supplied Headfox charging cable or a low watt charger. Avoid using fast chargers.

P/04

1.5 Safety Precautions

- The device is waterproof and can be used while riding in rain. Do not immerse the helmet in water or place it in any water body.
- If the product gets wet, keep it in a cool and dry place. Do not place it in an oven or any high-temperature area.
- Do not dispose of the device or battery in fire.
- Do not disassemble, repair, or modify the product.
- Keep charging port closed during riding or rain.

2 Using the Tarmac

2.1 Light Modes

The Tarmac Smart Helmet features an advanced rear lighting system that enhances visibility and rider communication on the road. More than a safety feature, these four light modes create a shared language among riders, expressing unity, mood, identity, and connection. Whether riding solo or in a group, every journey becomes a symbol of community on the road.

To turn ON & OFF the rear lights, press the (-) button three times. Once the lights are on, press the (-) button two times to switch between the available light modes. Repeat until the desired mode is selected.

2.2 Sound Modes

Tarmac Smart helmet features 3 optimized sound modes for different riding conditions:

Normal (Only Headphones)

Beast (Headphones & Subwoofer)

Chill (Only Subwoofer)

Press the (+) button three times to change between the available sound modes. Repeat until the desired mode is selected.

Note: The helmet remembers the last selected mode even after power off.

P/05



Want to customize your helmet?



Everything You Need for Better Rides

Scan QR Code to get spare parts of this helmet and accessories for daily rides

Visors | Accessories | Spare Parts



~ Make your every ride Great with Tarmac ~

P/08



Unlock The Technology

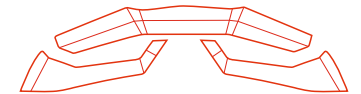

TARMAC

Bluetooth HELMETS



USER GUIDE